

MIDWAY 580 SPECIFICATION

2023

Ref Specification

- A Hull Specification – 58' Cruiser 10/6/4 mm – 43A Grade**
- 1 Gas Lockers, space for 2off 13kg bottles
 - 2 Single glazed 5 off Windows/4 off Ports – full opening. Choice TBC
 - 3 Roof Hatch
 - 4 Tiller & Pin
 - 5 Anodes – 4 No.
 - 6 Spray foam Roof and cabin and hull thermal insulation
 - 7 Bow thruster tube in watertight locker to suit 55KGF thruster
 - 8 Centre mooring eye
 - 9 1 set of side doors
 - 10 Full grit blast to hull prior to painting

B External Specification

- 1 Chrome mushroom vents
- 2 Head Light
- 3 Horn
- 4 One colour paint scheme with coach line and roof
- 5 Lower hull finished in intertuff type 16
- 6 Fenders
- 7 3 x ropes
- 8 Chimney and cover for when not in use
- 9 Loop to middle of roof for rope control
- 10 Non-slip to edge walkways
- 11 2 x Rear doors in steel lined in oak
- 12 2 x steel front doors lined in oak half glazed
- 13 Pole, boarding plank, and boat hook on trestle, 2 No. windlasses, 2 No. mooring stakes
- 14 Fairleads to centre rope
- 15 Paintwork finished in Epifanes

C Wood Specification

- 1 Oak varnished satin finish
- 2 Cabin sides – plywood with leatherette lining along with appropriate hard wood panelling
- 3 Hull side to be lined with Oak Veneer Panels
- 4 Roof to be lined with T&G effect ply and finished in white satin
- 5 Bulk Heads – ¾" double-sided Oak panels
- 6 All internal woodwork to be generally towards the style of illustration pictures shown
- 7 All internal doors to be rigid on opening and closing (i.e. not springing)
- 8 Hardwood shaker style doors

D Electrical Specification

- 1 2 wall lights in the lounge
- 2 2 reading lights over bed
- 3 Exterior landline connection
- 4 LED ceiling lights
- 5 Suitable 12v panel with trips,
- 6 Suitable 240v panel with relevant RCB

MIDWAY BOATS LTD,
BARBRIDGE MARINA, NANTIWCH ROAD,
WARDLE, NANTWICH,
CW5 6BE

MIDWAY 580 SPECIFICATION

- 7 Max of 7 240v twin sockets + quad 240V socket for TV
 8 Pelmet light in bathroom
 9 1 off battery for 55kgf thruster
 10 1 off Starter battery on base tray with top cover, secured
 11 3 off 110Ah wet acid domestic batteries on base tray with top cover, secured
 12 Wiring to allow for satellite & Coax- weatherproof socket within front cratch
 13 Pure Sine Wave 12v/2000w/70A Charger/Inverter/Compact
 14 As many items as are necessary to complete the electrical installation on the boat, including testing and wiring diagram
 15 Chrome electrical fittings
 16 Galvanic Isolator
- E Engine Specification**
 1 Beta Marine 38 Diesel engine, with PRM 125 mechanical gearbox, bilge-keel cooled
 2 Control Panel (over cupboard, near rear door, to starboard)
 3 Propeller
 4 Environmentally friendly, water lubricated stern gear
 5 40amp & 100amp alternators
 6 Panel includes Tachometer and warning lights for oil, temp and electrical faults
- F Gauges**
 1 See optional extras
- G Bedroom Specification**
 1 2off drawers
 2 Overhead cupboard above bedhead including 2 reading lights
 3 Steps with storage
 4 1off radiator opposite bed
 5 Double wardrobe adjacent bed
 6 flooring- carpet
- H Bathroom Specification**
 1 800mm quadrant shower, Fittings, & Pump
 2 Counter top hand basin with mixer tap
 3 Thetford ceramic cassette toilet (Pump out optional)
 4 Large mirror across bulkhead with light above
 5 1off heated, chrome towel rail
 7 Cupboards and shelves
 8 Hanex worktop
 9 Flooring- vinyl type (examples can be seen)
- I Galley Specification**
 1 Integrated fridge
 2 Single oven & grill
 3 Stainless under mount sink with mixer tap and drainer grooves
 4 Appropriate cupboard space Inc. 3 drawers
 5 Overhead storage
 7 microwave
 8 Hanex worktops tops – choice of colours available
 9 Flooring- vinyl type (examples can be seen)

MIDWAY 580 SPECIFICATION

- J Lounge Specification**
- 1 Multi fuel stove
 - 2 Unit housing for TV, with additional cupboards either side of fire and shelving adjacent to T.V with lighting
 - 3 2 off radiators
 - 4 Fireplace constructed to comply with guide lines
 - 5 Flooring- Carpet
- K Safety**
- 1 3 x Fire extinguishers and 1 x Fire Blanket
 - 2 2 x Carbon Monoxide Alarms
 - 3 Fire/smoke/heat alarms in bedroom
 - 4 Fire/smoke/heat alarm in kitchen (kitchen type) and lounge
- L Heating**
- 1 Webasto heating system, serving radiators and calorifier, valves, pipework and header tank. Calorifier with 2 x finned super coils, pressure release valve, and thermostatic mixer valve.
 - 2 Pressure vessel(s)
 - 3 Electric immersion heater 1 KW
 - 4 Multi fuel stove – diesel stove optional
 - 5 Fire surround and hearth, within guidelines
- M Water System**
- 1 Pump and combined Pressure Vessel
 - 2 Filter, connections from deck to tank & breather pipe
- N Furniture**
- 1 Curtains to windows (customer to supply material)
 - 2 Blinds to windows
 - 3 Blinds to front doors
- O Sundries**
- 1 Inspection hatches in floor at the rear

The above schedule sets out the basic requirements of the vessel. The Purchaser is entitled to request of the Builder additional items or variations, submitted to the builder in completion of a signed order form agreeing to additional items and prices.

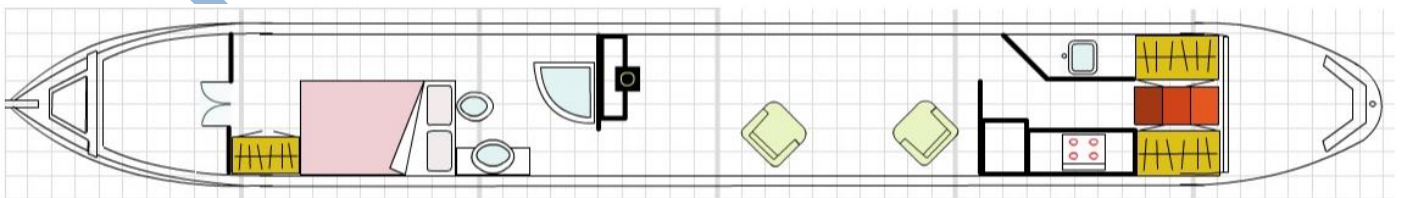

MIDWAY BOATS LTD,
BARBRIDGE MARINA, NANTIWCH ROAD,
WARDLE, NANTWICH,
CW5 6BE